

HOW TO INSTALL *blinds*

Installing our blinds is really easy and can save you a tonne of money. Because we don't have to install or measure ourselves, we don't charge you for that, and because you send us the measurements, we make your orders for you specifically, which saves us store room space meaning even more saving for you!

Simply follow the instructions below, and your blinds will be up in no time.

WHAT YOU WILL NEED

- Drill and drill bit (6mm recommended)
- 6mm nail in anchors
- Screwdriver
- Pencil
- Screws and Brackets

INSTALLATION INSTRUCTIONS

Step 1: Choose the Mounting Method

You can mount your blinds either on the wall or window frame (face mounting) or the ceiling or window lintel (recess mounting). **Select the mounting method you specified when ordering your blinds.

Note: The brackets shown below are only a representation of the brackets you may receive. Your actual brackets may vary slightly, but the installation procedure remains the same.

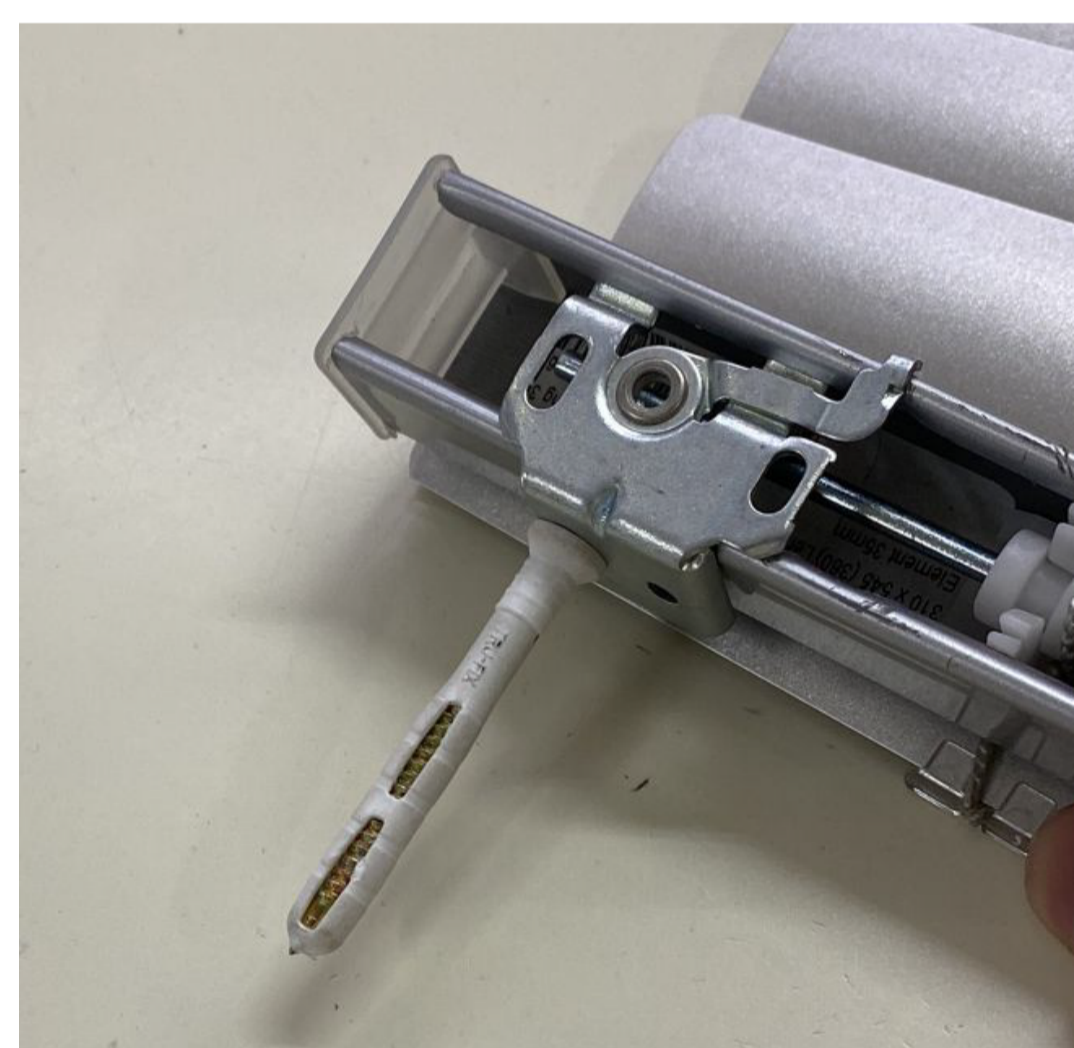

Step 2: Mark the Screw Holes

Hold the bracket against the wall or ceiling where you want to mount it, and use a pencil to mark the screw holes. Make sure the bracket is not positioned on top of the moving component parts, as this will affect the operation of the blind.

Step 3: Drill Pilot Holes and Insert Plugs

Drill pilot holes where you marked the screw holes. Insert the plugs into the drilled holes.

Step 4: Attach the Brackets

Use a screwdriver to attach the brackets to the wall or ceiling using the screws. Ensure the brackets are level and aligned with each other and that they are the correct distance apart.

Step 5: Clip the Blind Underneath the Brackets

Clip the blind underneath the brackets. Make sure that the blind cord and tilt cord collar face you, not away from you.

Job well done! Enjoy the privacy and style of your new blinds.